

John Bear

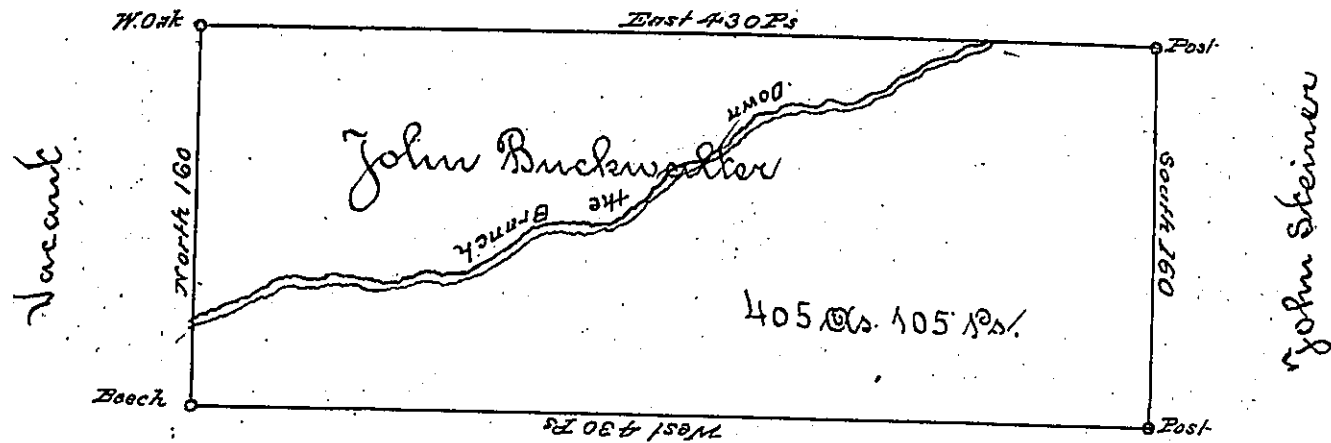

Situated on the Waters of Two Lick & Creek in Wheatfield Township, Westmoreland County, containing 405 Acres & 105 perches & allowance of six per Cent for Roads &c Surveyed for John Buckwalter the 24th Day of Decem^r 1794 on Warrant dated the 5th Day of May 1793 ~

Daniel Broadhead Esq^r D. S.

James Ross D. S.

IN TESTIMONY that the above is a copy of the original remaining on file in the Department of Internal Affairs of Pennsylvania, made conformably to an Act of Assembly approved the 16th day of February, 1833, I have hereunto set my Hand and caused the Seal of said Department to be affixed at Harrisburg, this

first day of August 1894

[Signature]
Secretary of Internal Affairs